

- NOTES:
- THIS DRAWING IS TO BE READ IN CONJUNCTION WITH ALL DRAWINGS LISTED ON STPJ578-ARC-000-23-DRG-HE-00001.
 - BACK OF THE FOOTWAY LEVELS TO BE RETAINED.
 - ALL ROAD MARKINGS ARE TO BE SET OUT IN ACCORDANCE WITH T.S.R.G.D 2016. PROPOSED MARKINGS ARE SHOWN IN RED, BLACK OR YELLOW.
 - FOR FULL LANDSCAPING DESIGN REFER TO STPJ578-ARC-300-23-DRG-LA-00005.
 - FOR FULL DRAINAGE DESIGN REFER TO STPJ578-ARC-050-23-DRG-LA-00001 TO STPJ578-ARC-050-23-DRG-LA-00005.
 - FOR FULL PAVEMENT DESIGN REFER TO STPJ578-ARC-070-23-DRG-LA-00001 TO STPJ578-ARC-070-23-DRG-LA-00005.
- HEALTH AND SAFETY:
- HEALTH AND SAFETY SYMBOL AND REFERENCE NUMBER, TO BE READ IN CONJUNCTION WITH THE DESIGN RISK REGISTER
- STPJ578-001 STPJ578-ARC-XXX-23-HSE-ZZ-00001

- KEY CONTINUED:
- | | | | |
|-----|--|-------|--|
| RS | PROPOSED CANTILEVER POST AND SIGN | B | PROPOSED BOLLARD AND SIGN |
| LC | PROPOSED SIGN MOUNTED ON EXISTING LIGHTING COLUMN | RS | PROPOSED POST AND SIGN |
| SNP | PROPOSED STREET NAME PLATE | ○ | PROPOSED POST FOUNDATION FOOTPRINTS |
| RS | RELOCATED POST AND SIGN | TS | PROPOSED TRAFFIC SIGNAL TO BE INSTALLED BY TFL |
| SNP | RELOCATED STREET NAME PLATE | LC | PROPOSED LIGHTING COLUMN |
| RS | RELOCATED SIGN MOUNTED ON PROPOSED POST | NG | PROPOSED GULLY |
| LC | RELOCATED SIGN MOUNTED ON PROPOSED POST | IGP | PROPOSED ILLUMINATED GUIDE POST |
| LL | PROPOSED LEGIBLE LONDON MONOLITH SIGN | B | PROPOSED BOLLARD |
| LL | PROPOSED LEGIBLE LONDON FINGER POST | BEN | PROPOSED BENCH |
| WBP | RELOCATED SIGN MOUNTED ON PROPOSED WIDE BASED POST | CG | EXISTING GULLY |
| WBP | RELOCATED WIDE BASED POST AND SIGN | HCCTV | EXISTING CCTV COLUMN |
| | | FP | EXISTING FEEDER PILLAR |
| | | CAB | EXISTING CONTROL CABINET |

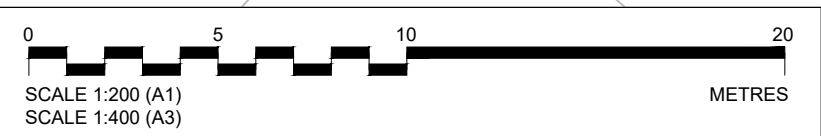
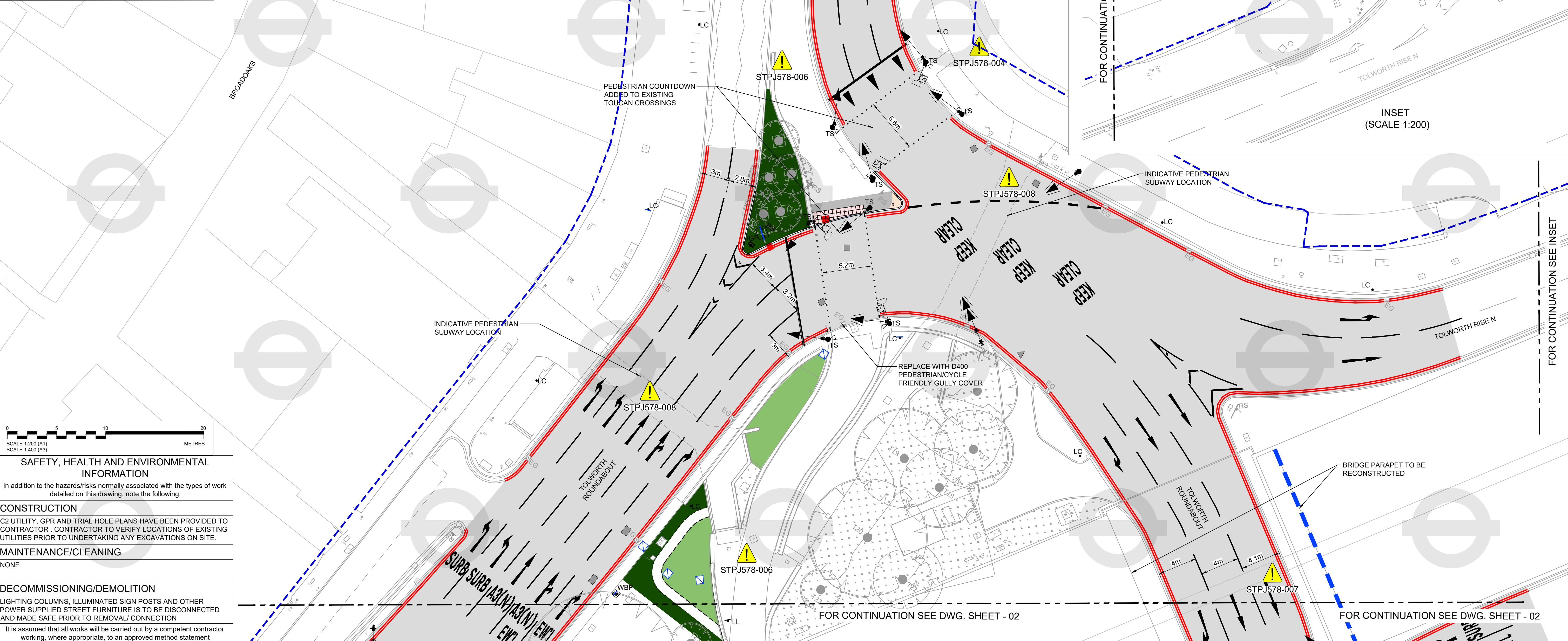

SAFETY, HEALTH AND ENVIRONMENTAL INFORMATION

In addition to the hazards/risks normally associated with the types of work detailed on this drawing, note the following:

CONSTRUCTION

C2 UTILITY, GPR AND TRIAL HOLE PLANS HAVE BEEN PROVIDED TO CONTRACTOR. CONTRACTOR TO VERIFY LOCATIONS OF EXISTING UTILITIES PRIOR TO UNDERTAKING ANY EXCAVATIONS ON SITE.

MAINTENANCE/CLEANING

NONE

DECOMMISSIONING/DEMOLITION

LIGHTING COLUMNS, ILLUMINATED SIGN POSTS AND OTHER POWER SUPPLIED STREET FURNITURE IS TO BE DISCONNECTED AND MADE SAFE PRIOR TO REMOVAL/ CONNECTION

It is assumed that all works will be carried out by a competent contractor working, where appropriate, to an approved method statement

KEY PLAN:

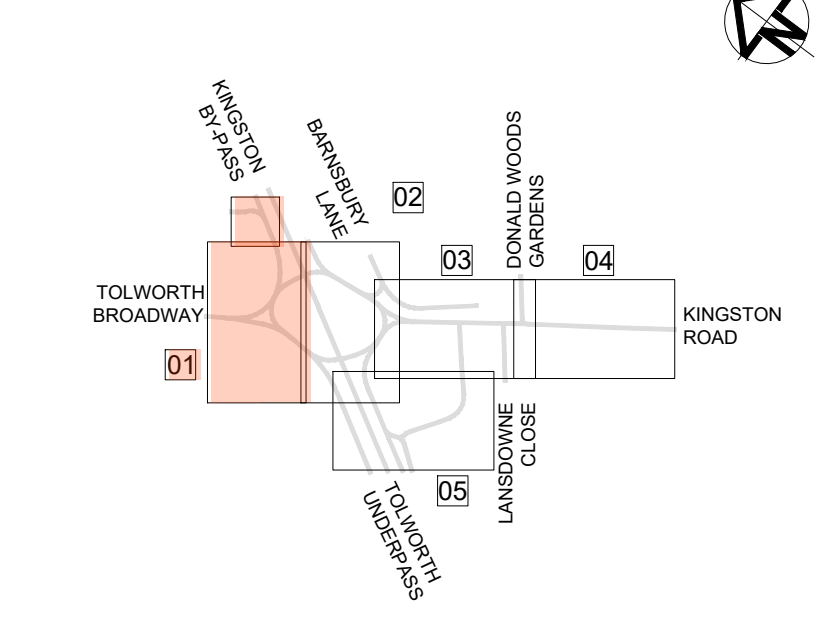

- KEY
- | | |
|--|--|
| PROPOSED PERMEABLE ARTIFICIAL STONE PAVERS | PROPOSED CARRIAGEWAY ASPHALT |
| PROPOSED ARTIFICIAL STONE PAVERS | PROPOSED LOW LEVEL PLANTING/SHRUBS AREA |
| PROPOSED CONCRETE BLOCK PAVING | PROPOSED RAIN GARDEN AREA |
| PROPOSED CYCLEWAY ASPHALT | PROPOSED GRASSCRETE AREA |
| PROPOSED FOOTWAY ASPHALT | PROPOSED BULB PLANTING |
| PROPOSED ASPHALT ON EXISTING CARRIAGEWAY | PROPOSED THERMOPLASTIC TREATMENT TO EXISTING ASPHALT SURFACE |
| | TLRN HIGHWAY BOUNDARY |

- | | |
|--|---|
| PROPOSED GABION BASKETS | PROPOSED RAMP COVER TO BE RAISED/ LOWERED TO SUIT NEW LEVELS |
| PROPOSED CONCRETE TRAMLINE PAVING | EXISTING COVER TO BE RECESSED BY OTHERS |
| PROPOSED INSITU POURED CONCRETE KERB BACKING | COVER AND CHAMBER TO BE REBUILT TO CARRIAGEWAY SPECIFICATION TO SUIT NEW LEVELS (BY OTHERS) |
| PROPOSED KERB | COVERS TO BE REMOVED OR RELOCATED (BY OTHERS) |
| PROPOSED CHAMFERED KERB | PROPOSED CATCHPIT WITH D400 COVER |
| PROPOSED FLUSH KERB | PROPOSED TREE |
| PROPOSED CHAMFERED CYCLEWAY DELINEATOR KERB | PROPOSED NEW TREE PIT WITH BREEDON GOLDEN AMBER GRAVEL |
| PROPOSED KERB DROPPER | |
| PROPOSED QUADRANT KERB | |
| PROPOSED EDGING KERB | |
| PROPOSED ARTIFICIAL STONE CHARCOAL COLOURED TACTILE PAVING | |
| PROPOSED ARTIFICIAL STONE RED COLOURED TACTILE PAVING | |

SECURITY									
Rev	Date	Purpose / Description	Drawn	T. Checked	T. Approved	P. Approved	Authorised		
P01	07/09/22	FIRST ISSUE	AM	GN	CB	KT			
P02	09/12/22	DETAILED DESIGN	ET	CP	CB	TR			
P03	09/02/23	Revised in line with TfL comments	ET	GN	CB	TR			

Project	Tolworth Roundabout
Originator	ARC
Location	23
Asset Classification	010
Lifecycle	Suitable for Stage Approval

Title	TOLWORTH ROUNDABOUT GENERAL ARRANGEMENT (SHEET 1 of 5)
Drawing Number	STPJ578-ARC-010-23-DRG-HE-00001
Rev.	P03